

# SIAM/EDO

## FRONT PLATE

### FACE AVANT

#### Description

Material : full brass.

Windows opening : 1 round hole + 1 rectangular hole for PB (E).

Button: rectangular button.

Silicone: to reduce sound impact between buttons and face plate.

POSITION

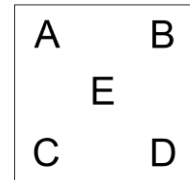

#### Caractéristiques

Matière : laiton massif.

Fenêtre : 1 ouverture ronde + 1 ouverture rectangulaire pour BP (E).

Bouton: bouton rectangulaire.

Silicone : réduit l'impacte du son entre le bouton et la face avant.

Ref.	Finish	Finition	Effect	Effet
PSI171LMH	Polished mirror brass	Laiton miroir	Shiny	Brillant
PSI171LBH	Brushed brass	Laiton brossé	Matt	Mat
PSI171LSH	Microbilled/satin brass	Laiton microbillé	Satin	Satin
PSI171VOH	Antique/old gold	Vieil or	Matt	Mat
PSI171BMH	Medium bronze	Bronze moyen	Matt	Mat
PSI171BRH	Dark bronze	Bronze noir	Shiny	Brillant
PSI171BZH	Grey bronze	Bronze gris	Matt	Mat
PSI171NMH	Polished mirror nickel	Nickel miroir	Shiny	Brillant
PSI171NBH	Brushed nickel	Nickel brossé	Matt	Mat
PSI171NSH	Microbilled/satin nickel	Nickel brossé	Matt	Mat
PSI171CHH	Polished mirror chrome	Chrome miroir	Shiny	Brillant
PSI171ROH	Brushed copper	Cuivre brossé	Matt	Mat
PSI171RAH	RAL code 9003	RAL codes 9003	Matt	Mat
PSI171ORH	24K gold	24K or	Shiny	Brillant
PSI171OMH	24K microbilled gold	microbillé 24K or	Satin	Satin

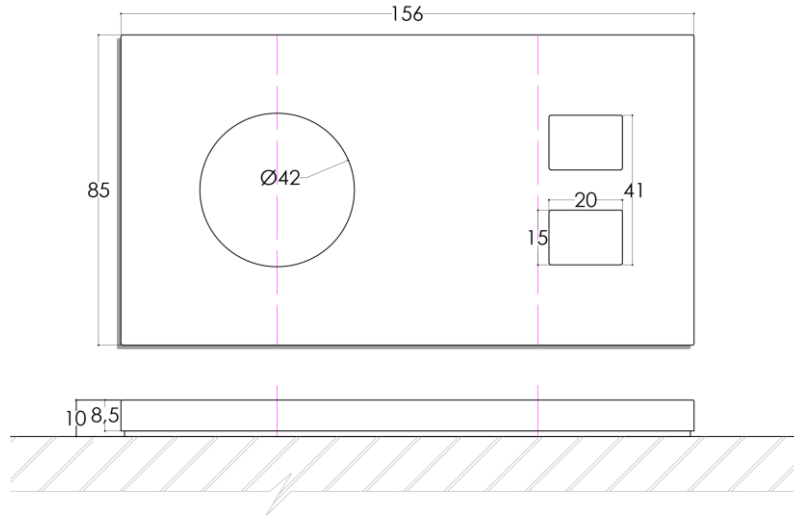

# SIAM/EDO

## FRONT PLATE

### FACE AVANT

#### Description

Material : full brass.

Windows opening : 1 round hole + 2 rectangular holes for PB (BD).

Button: rectangular buttons.

Silicone: to reduce sound impact between buttons and face plate.

POSITION

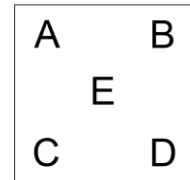

#### Caractéristiques

Matière : laiton massif.

Fenêtre : 1 ouverture ronde + 2 ouvertures rectangulaires pour BP (BD).

Bouton: boutons rectangulaires.

Silicone : réduit l'impacte du son entre le bouton et la face avant.

Ref.	Finish	Finition	Effect	Effet
PSI172LMH	Polished mirror brass	Laiton miroir	Shiny	Brillant
PSI172LBH	Brushed brass	Laiton brossé	Matt	Mat
PSI172LSH	Microbilled/satin brass	Laiton microbillé	Satin	Satin
PSI172VOH	Antique/old gold	Vieil or	Matt	Mat
PSI172BMH	Medium bronze	Bronze moyen	Matt	Mat
PSI172BRH	Dark bronze	Bronze noir	Shiny	Brillant
PSI172BZH	Grey bronze	Bronze gris	Matt	Mat
PSI172NMH	Polished mirror nickel	Nickel miroir	Shiny	Brillant
PSI172NBH	Brushed nickel	Nickel brossé	Matt	Mat
PSI172NSH	Microbilled/satin nickel	Nickel brossé	Matt	Mat
PSI172CHH	Polished mirror chrome	Chrome miroir	Shiny	Brillant
PSI172ROH	Brushed copper	Cuivre brossé	Matt	Mat
PSI172RAH	RAL code 9003	RAL codes 9003	Matt	Mat
PSI172ORH	24K gold	24K or	Shiny	Brillant
PSI172OMH	24K microbilled gold	microbillé 24K or	Satin	Satin

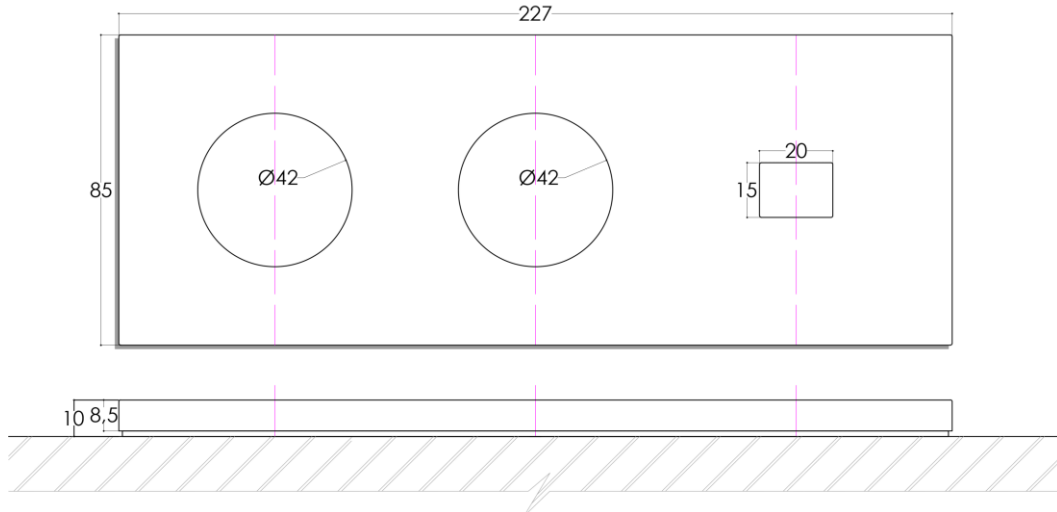

# SIAM/EDO

## FRONT PLATE

### FACE AVANT

POSITION

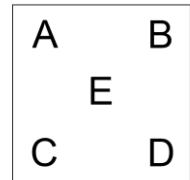

#### Description

Material : full brass.

Windows opening : 2 round hole + 1 rectangular holes for PB (E).

Button: rectangular button.

Silicone: to reduce sound impact between buttons and face plate.

#### Caractéristiques

Matière : laiton massif.

Fenêtre : 2 ouvertures rondes + 1 ouverture rectangulaire pour BP (E).

Bouton: bouton rectangulaire.

Silicone : réduit l'impacte du son entre le bouton et la face avant.

Ref.	Finish	Finition	Effect	Effet
PSI173LMH	Polished mirror brass	Laiton miroir	Shiny	Brillant
PSI173LBH	Brushed brass	Laiton brossé	Matt	Mat
PSI173LSH	Microbilled/satin brass	Laiton microbillé	Satin	Satin
PSI173VOH	Antique/old gold	Vieil or	Matt	Mat
PSI173BMH	Medium bronze	Bronze moyen	Matt	Mat
PSI173BRH	Dark bronze	Bronze noir	Shiny	Brillant
PSI173BZH	Grey bronze	Bronze gris	Matt	Mat
PSI173NMH	Polished mirror nickel	Nickel miroir	Shiny	Brillant
PSI173NBH	Brushed nickel	Nickel brossé	Matt	Mat
PSI173NSH	Microbilled/satin nickel	Nickel brossé	Matt	Mat
PSI173CHH	Polished mirror chrome	Chrome miroir	Shiny	Brillant
PSI173ROH	Brushed copper	Cuivre brossé	Matt	Mat
PSI173RAH	RAL code 9003	RAL codes 9003	Matt	Mat
PSI173ORH	24K gold	24K or	Shiny	Brillant
PSI173OMH	24K microbilled gold	microbillé 24K or	Satin	Satin

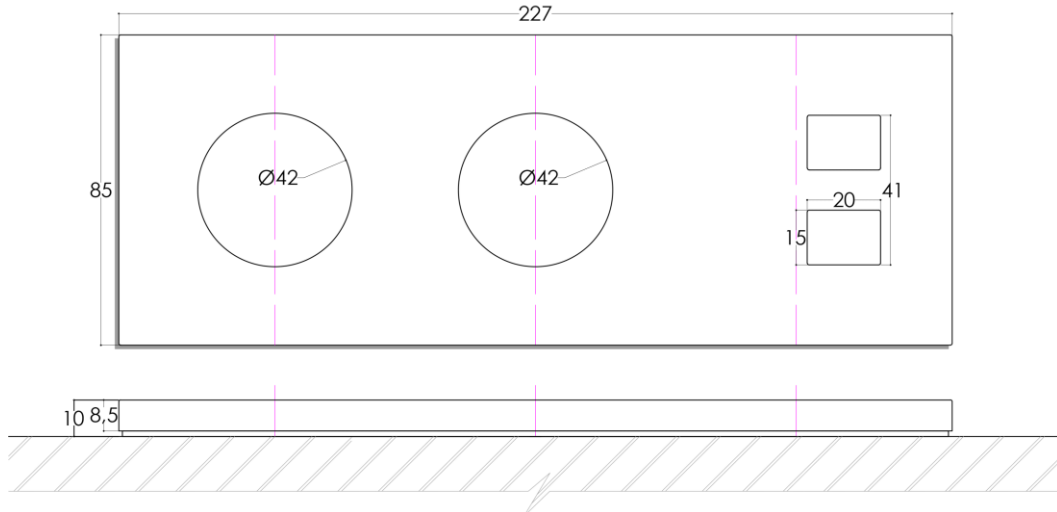

# SIAM/EDO

## FRONT PLATE

### FACE AVANT

POSITION

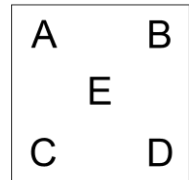

#### Description

Material : full brass.

Windows opening : 2 round holes + 2 rectangular holes for PB (BD).

Button: rectangular buttons.

Silicone: to reduce sound impact between buttons and face plate.

#### Caractéristiques

Matière : laiton massif.

Fenêtre : 2 ouvertures rondes + 2 ouvertures rectangulaires pour BP (BD).

Bouton: boutons rectangulaires.

Silicone : réduit l'impacte du son entre le bouton et la face avant.

Ref.	Finish	Finition	Effect	Effet
PSI174LMH	Polished mirror brass	Laiton miroir	Shiny	Brillant
PSI174LBH	Brushed brass	Laiton brossé	Matt	Mat
PSI174LSH	Microbilled/satin brass	Laiton microbillé	Satin	Satin
PSI174VOH	Antique/old gold	Vieil or	Matt	Mat
PSI174BMH	Medium bronze	Bronze moyen	Matt	Mat
PSI174BRH	Dark bronze	Bronze noir	Shiny	Brillant
PSI174BZH	Grey bronze	Bronze gris	Matt	Mat
PSI174NMH	Polished mirror nickel	Nickel miroir	Shiny	Brillant
PSI174NBH	Brushed nickel	Nickel brossé	Matt	Mat
PSI174NSH	Microbilled/satin nickel	Nickel brossé	Matt	Mat
PSI174CHH	Polished mirror chrome	Chrome miroir	Shiny	Brillant
PSI174ROH	Brushed copper	Cuivre brossé	Matt	Mat
PSI174RAH	RAL code 9003	RAL codes 9003	Matt	Mat
PSI174ORH	24K gold	24K or	Shiny	Brillant
PSI174OMH	24K microbilled gold	microbillé 24K or	Satin	Satin