

NEVA

FRONT PLATE

FACE AVANT

Description

Material : full brass.
 Windows opening : 1 round hole for PB (E).
 Button: round button.
 Silicone: to reduce sound impact between buttons and face plate.

POSITION

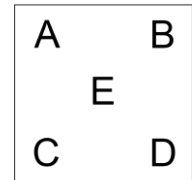

Caractéristiques

Matière : laiton massif.
 Fenêtre : 1 ouverture ronde pour BP (E).
 Bouton: bouton rond.
 Silicone : réduit l'impacte du son entre le bouton et la face avant.

Ref.	Finish	Finition	Effect	Effet
PNV001LM	Polished mirror brass	Laiton miroir	Shiny	Brillant
PNV001LB	Brushed brass	Laiton brossé	Matt	Mat
PNV001LS	Microbilled/satin brass	Laiton microbillé	Satin	Satin
PNV001VO	Antique/old gold	Vieil or	Matt	Mat
PNV001BM	Medium bronze	Bronze moyen	Matt	Mat
PNV001BR	Dark bronze	Bronze noir	Shiny	Brillant
PNV001BZ	Grey bronze	Bronze gris	Matt	Mat
PNV001NM	Polished mirror nickel	Nickel miroir	Shiny	Brillant
PNV001NB	Brushed nickel	Nickel brossé	Matt	Mat
PNV001NS	Microbilled/satin nickel	Nickel brossé	Matt	Mat
PNV001CH	Polished mirror chrome	Chrome miroir	Shiny	Brillant
PNV001RO	Brushed copper	Cuivre brossé	Matt	Mat
PNV001RA	RAL code 9003	RAL codes 9003	Matt	Mat
PNV001OR	24K gold	24K or	Shiny	Brillant
PNV001OM	24K microbilled gold	microbillé 24K or	Satin	Satin

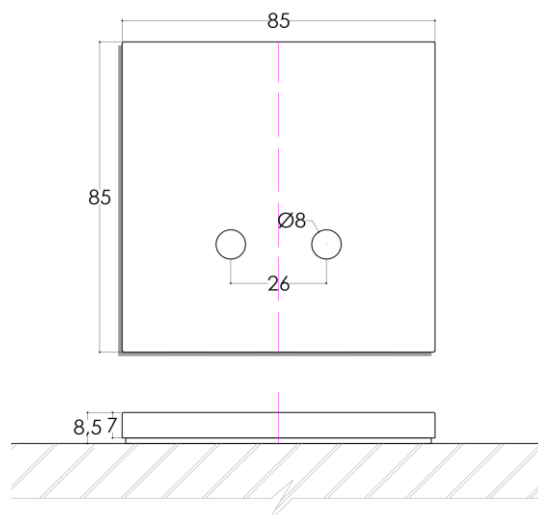

NEVA

FRONT PLATE

FACE AVANT

Description

Material : full brass.

Windows opening : 2 round holes for PB (CD).

Button: round buttons.

Silicone: to reduce sound impact between buttons and face plate.

Caractéristiques

Matière : laiton massif.

Fenêtre : 2 ouvertures rondes pour BP (CD).

Bouton: boutons ronds.

Silicone : réduit l'impacte du son entre le bouton et la face avant.

POSITION

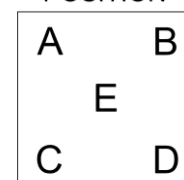

Ref.	Finish	Finition	Effect	Effet
PNV002LM	Polished mirror brass	Laiton miroir	Shiny	Brillant
PNV002LB	Brushed brass	Laiton brossé	Matt	Mat
PNV002LS	Microbilled/satin brass	Laiton microbillé	Satin	Satin
PNV002VO	Antique/old gold	Vieil or	Matt	Mat
PNV002BM	Medium bronze	Bronze moyen	Matt	Mat
PNV002BR	Dark bronze	Bronze noir	Shiny	Brillant
PNV002BZ	Grey bronze	Bronze gris	Matt	Mat
PNV002NM	Polished mirror nickel	Nickel miroir	Shiny	Brillant
PNV002NB	Brushed nickel	Nickel brossé	Matt	Mat
PNV002NS	Microbilled/satin nickel	Nickel brossé	Matt	Mat
PNV002CH	Polished mirror chrome	Chrome miroir	Shiny	Brillant
PNV002RO	Brushed copper	Cuivre brossé	Matt	Mat
PNV002RA	RAL code 9003	RAL codes 9003	Matt	Mat
PNV002OR	24K gold	24K or	Shiny	Brillant
PNV002OM	24K microbilled gold	microbillé 24K or	Satin	Satin

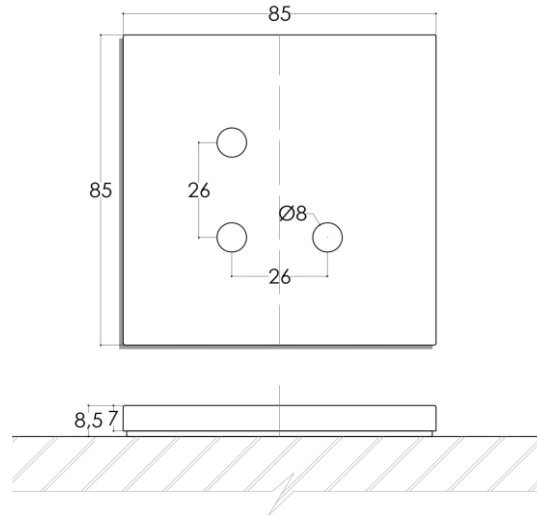

NEVA

FRONT PLATE

FACE AVANT

Description

Material : full brass.
 Windows opening : 3 round holes for PB (ACD).
 Button: round buttons.
 Silicone: to reduce sound impact between buttons and face plate.

POSITION

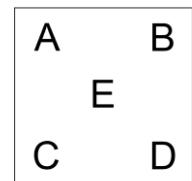

Caractéristiques

Matière : laiton massif.
 Fenêtre : 3 ouvertures rondes pour BP (ACD).
 Bouton: boutons ronds.
 Silicone : réduit l'impacte du son entre le bouton et la face avant.

Ref.	Finish	Finition	Effect	Effet
PNV003LM	Polished mirror brass	Laiton miroir	Shiny	Brillant
PNV003LB	Brushed brass	Laiton brossé	Matt	Mat
PNV003LS	Microbilled/satin brass	Laiton microbillé	Satin	Satin
PNV003VO	Antique/old gold	Vieil or	Matt	Mat
PNV003BM	Medium bronze	Bronze moyen	Matt	Mat
PNV003BR	Dark bronze	Bronze noir	Shiny	Brillant
PNV003BZ	Grey bronze	Bronze gris	Matt	Mat
PNV003NM	Polished mirror nickel	Nickel miroir	Shiny	Brillant
PNV003NB	Brushed nickel	Nickel brossé	Matt	Mat
PNV003NS	Microbilled/satin nickel	Nickel brossé	Matt	Mat
PNV003CH	Polished mirror chrome	Chrome miroir	Shiny	Brillant
PNV003RO	Brushed copper	Cuivre brossé	Matt	Mat
PNV003RA	RAL code 9003	RAL codes 9003	Matt	Mat
PNV003OR	24K gold	24K or	Shiny	Brillant
PNV003OM	24K microbilled gold	microbillé 24K or	Satin	Satin

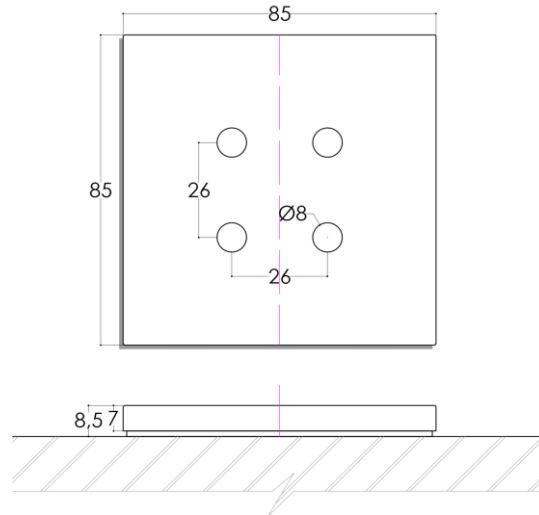

NEVA

FRONT PLATE

FACE AVANT

Description

Material : full brass.

Windows opening : 4 round holes for PB (ABCD).

Button: round buttons.

Silicone: to reduce sound impact between buttons and face plate.

POSITION

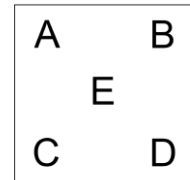

Caractéristiques

Matière : laiton massif.

Fenêtre : 4 ouvertures rondes pour BP (ABCD).

Bouton: boutons ronds.

Silicone : réduit l'impacte du son entre le bouton et la face avant.

Ref.	Finish	Finition	Effect	Effet
PNV004LM	Polished mirror brass	Laiton miroir	Shiny	Brillant
PNV004LB	Brushed brass	Laiton brossé	Matt	Mat
PNV004LS	Microbilled/satin brass	Laiton microbillé	Satin	Satin
PNV004VO	Antique/old gold	Vieil or	Matt	Mat
PNV004BM	Medium bronze	Bronze moyen	Matt	Mat
PNV004BR	Dark bronze	Bronze noir	Shiny	Brillant
PNV004BZ	Grey bronze	Bronze gris	Matt	Mat
PNV004NM	Polished mirror nickel	Nickel miroir	Shiny	Brillant
PNV004NB	Brushed nickel	Nickel brossé	Matt	Mat
PNV004NS	Microbilled/satin nickel	Nickel brossé	Matt	Mat
PNV004CH	Polished mirror chrome	Chrome miroir	Shiny	Brillant
PNV004RO	Brushed copper	Cuivre brossé	Matt	Mat
PNV004RA	RAL code 9003	RAL codes 9003	Matt	Mat
PNV004OR	24K gold	24K or	Shiny	Brillant
PNV004OM	24K microbilled gold	microbillé 24K or	Satin	Satin

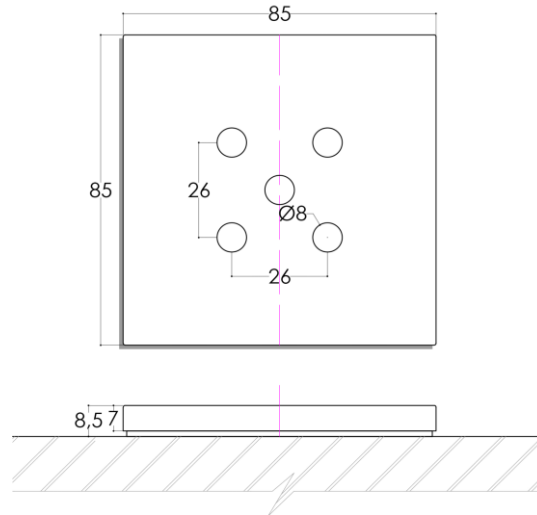

NEVA

FRONT PLATE

FACE AVANT

Description

Material : full brass.

Windows opening : 5 round holes for PB (ABCDE).

Button: round buttons.

Silicone: to reduce sound impact between buttons and face plate.

POSITION

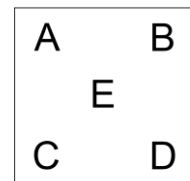

Caractéristiques

Matière : laiton massif.

Fenêtre : 5 ouvertures rondes pour BP (ABCD).

Bouton: boutons ronds.

Silicone : réduit l'impacte du son entre le bouton et la face avant.

Ref.	Finish	Finition	Effect	Effet
PNV005LM	Polished mirror brass	Laiton miroir	Shiny	Brillant
PNV005LB	Brushed brass	Laiton brossé	Matt	Mat
PNV005LS	Microbilled/satin brass	Laiton microbillé	Satin	Satin
PNV005VO	Antique/old gold	Vieil or	Matt	Mat
PNV005BM	Medium bronze	Bronze moyen	Matt	Mat
PNV005BR	Dark bronze	Bronze noir	Shiny	Brillant
PNV005BZ	Grey bronze	Bronze gris	Matt	Mat
PNV005NM	Polished mirror nickel	Nickel miroir	Shiny	Brillant
PNV005NB	Brushed nickel	Nickel brossé	Matt	Mat
PNV005NS	Microbilled/satin nickel	Nickel brossé	Matt	Mat
PNV005CH	Polished mirror chrome	Chrome miroir	Shiny	Brillant
PNV005RO	Brushed copper	Cuivre brossé	Matt	Mat
PNV005RA	RAL code 9003	RAL codes 9003	Matt	Mat
PNV005OR	24K gold	24K or	Shiny	Brillant
PNV005OM	24K microbilled gold	microbillé 24K or	Satin	Satin

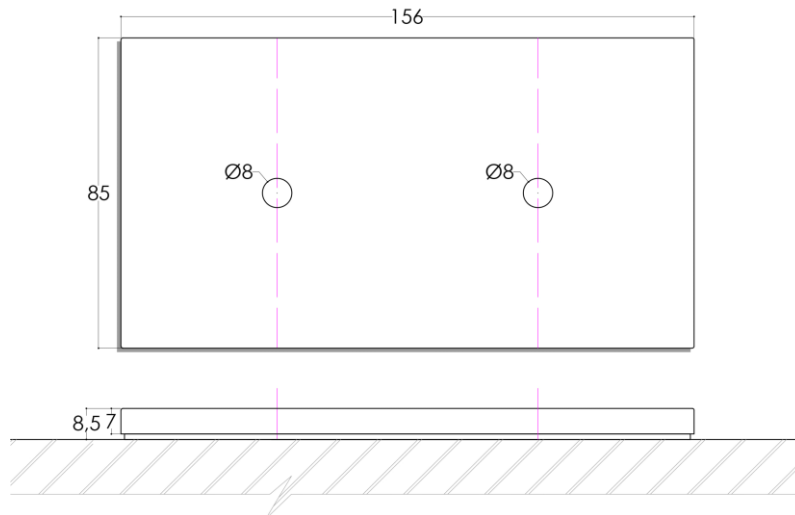

NEVA

FRONT PLATE

FACE AVANT

Description

Material : full brass.

Windows opening : 2 round holes for PB (E,E).

Button: round buttons.

Silicone: to reduce sound impact between buttons and face plate.

POSITION

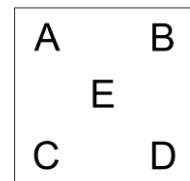

Caractéristiques

Matière : laiton massif.

Fenêtre : 2 ouvertures rondes pour BP (E,E).

Bouton: boutons ronds.

Silicone : réduit l'impacte du son entre le bouton et la face avant.

Ref.	Finish	Finition	Effect	Effet
PNV006LMH	Polished mirror brass	Laiton miroir	Shiny	Brillant
PNV006LBH	Brushed brass	Laiton brossé	Matt	Mat
PNV006LSH	Microbilled/satin brass	Laiton microbillé	Satin	Satin
PNV006VOH	Antique/old gold	Vieil or	Matt	Mat
PNV006BMH	Medium bronze	Bronze moyen	Matt	Mat
PNV006BRH	Dark bronze	Bronze noir	Shiny	Brillant
PNV006BZH	Grey bronze	Bronze gris	Matt	Mat
PNV006NMH	Polished mirror nickel	Nickel miroir	Shiny	Brillant
PNV006NBH	Brushed nickel	Nickel brossé	Matt	Mat
PNV006NSH	Microbilled/satin nickel	Nickel brossé	Matt	Mat
PNV006CHH	Polished mirror chrome	Chrome miroir	Shiny	Brillant
PNV006ROH	Brushed copper	Cuivre brossé	Matt	Mat
PNV006RAH	RAL code 9003	RAL codes 9003	Matt	Mat
PNV006ORH	24K gold	24K or	Shiny	Brillant
PNV006OMH	24K microbilled gold	microbillé 24K or	Satin	Satin

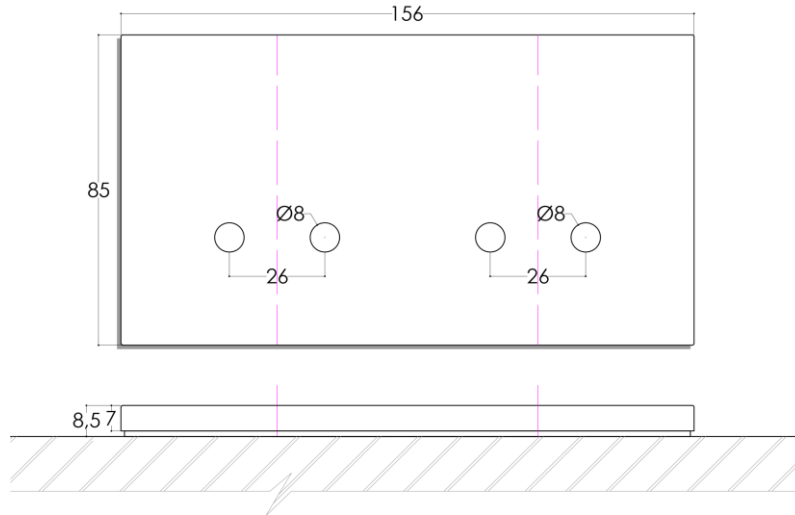

NEVA

FRONT PLATE

FACE AVANT

Description

Material : full brass.

Windows opening : 4 round holes for PB (C, D).

Button: round buttons.

Silicone: to reduce sound impact between buttons and face plate.

POSITION

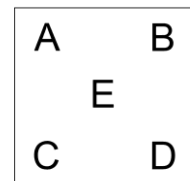

Caractéristiques

Matière : laiton massif.

Fenêtre : 4 ouvertures rondes pour BP (C, D).

Bouton: boutons ronds.

Silicone : réduit l'impacte du son entre le bouton et la face avant.

Ref.	Finish	Finition	Effect	Effet
PNV007LMH	Polished mirror brass	Laiton miroir	Shiny	Brillant
PNV007LBH	Brushed brass	Laiton brossé	Matt	Mat
PNV007LSH	Microbilled/satin brass	Laiton microbillé	Satin	Satin
PNV007VOH	Antique/old gold	Vieil or	Matt	Mat
PNV007BMH	Medium bronze	Bronze moyen	Matt	Mat
PNV007BRH	Dark bronze	Bronze noir	Shiny	Brillant
PNV007BZH	Grey bronze	Bronze gris	Matt	Mat
PNV007NMH	Polished mirror nickel	Nickel miroir	Shiny	Brillant
PNV007NBH	Brushed nickel	Nickel brossé	Matt	Mat
PNV007NSH	Microbilled/satin nickel	Nickel brossé	Matt	Mat
PNV007CHH	Polished mirror chrome	Chrome miroir	Shiny	Brillant
PNV007ROH	Brushed copper	Cuivre brossé	Matt	Mat
PNV007RAH	RAL code 9003	RAL codes 9003	Matt	Mat
PNV007ORH	24K gold	24K or	Shiny	Brillant
PNV007OMH	24K microbilled gold	microbillé 24K or	Satin	Satin

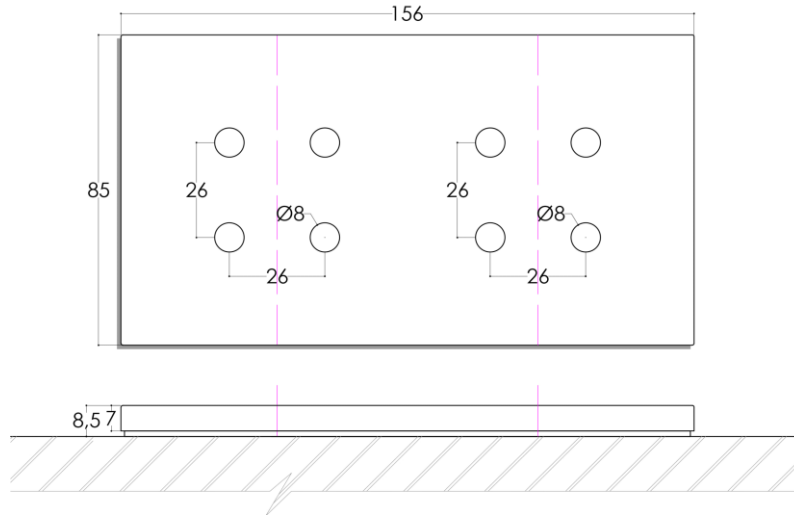

NEVA

FRONT PLATE

FACE AVANT

Description

Material : full brass.

Windows opening : 8 round holes for PB (ABCD, ABCD).

Button: round buttons.

Silicone: to reduce sound impact between buttons and face plate.

POSITION

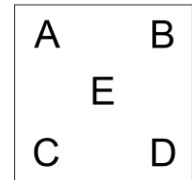

Caractéristiques

Matière : laiton massif.

Fenêtre : 8 ouvertures rondes pour BP (ABCD, ABCD).

Bouton: boutons ronds.

Silicone : réduit l'impacte du son entre le bouton et la face avant.

Ref.	Finish	Finition	Effect	Effet
PNV009LMH	Polished mirror brass	Laiton miroir	Shiny	Brillant
PNV009LBH	Brushed brass	Laiton brossé	Matt	Mat
PNV009LSH	Microbilled/satin brass	Laiton microbillé	Satin	Satin
PNV009VOH	Antique/old gold	Vieil or	Matt	Mat
PNV009BMH	Medium bronze	Bronze moyen	Matt	Mat
PNV009BRH	Dark bronze	Bronze noir	Shiny	Brillant
PNV009BZH	Grey bronze	Bronze gris	Matt	Mat
PNV009NMH	Polished mirror nickel	Nickel miroir	Shiny	Brillant
PNV009NBH	Brushed nickel	Nickel brossé	Matt	Mat
PNV009NSH	Microbilled/satin nickel	Nickel brossé	Matt	Mat
PNV009CHH	Polished mirror chrome	Chrome miroir	Shiny	Brillant
PNV009ROH	Brushed copper	Cuivre brossé	Matt	Mat
PNV009RAH	RAL code 9003	RAL codes 9003	Matt	Mat
PNV009ORH	24K gold	24K or	Shiny	Brillant
PNV009OMH	24K microbilled gold	microbillé 24K or	Satin	Satin

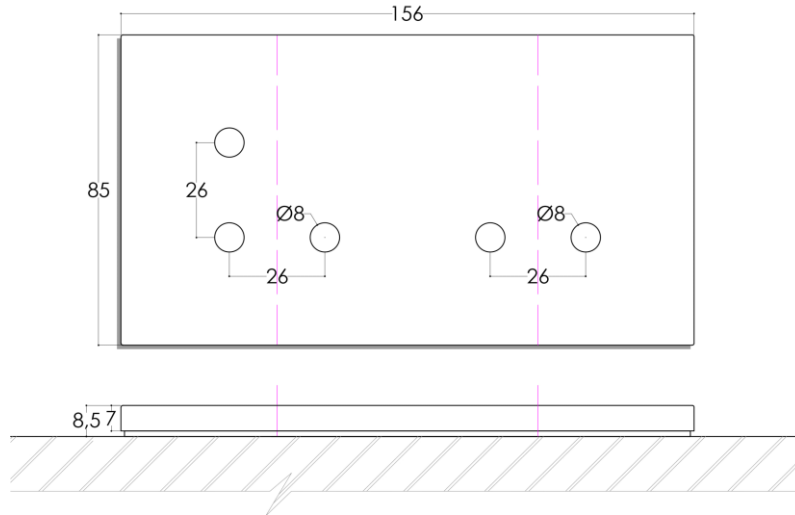

NEVA

FRONT PLATE

FACE AVANT

Description

Material : full brass.

Windows opening : 5 round holes for PB (ACD, CD).

Button: round buttons.

Silicone: to reduce sound impact between buttons and face plate.

POSITION

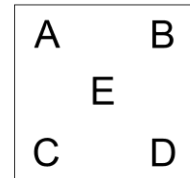

Caractéristiques

Matière : laiton massif.

Fenêtre : 5 ouvertures rondes pour BP (ACD, CD).

Bouton: boutons ronds.

Silicone : réduit l'impacte du son entre le bouton et la face avant.

Ref.	Finish	Finition	Effect	Effet
PNV107LMH	Polished mirror brass	Laiton miroir	Shiny	Brillant
PNV107LBH	Brushed brass	Laiton brossé	Matt	Mat
PNV107LSH	Microbilled/satin brass	Laiton microbillé	Satin	Satin
PNV107VOH	Antique/old gold	Vieil or	Matt	Mat
PNV107BMH	Medium bronze	Bronze moyen	Matt	Mat
PNV107BRH	Dark bronze	Bronze noir	Shiny	Brillant
PNV107BZH	Grey bronze	Bronze gris	Matt	Mat
PNV107NMH	Polished mirror nickel	Nickel miroir	Shiny	Brillant
PNV107NBH	Brushed nickel	Nickel brossé	Matt	Mat
PNV107NSH	Microbilled/satin nickel	Nickel brossé	Matt	Mat
PNV107CHH	Polished mirror chrome	Chrome miroir	Shiny	Brillant
PNV107ROH	Brushed copper	Cuivre brossé	Matt	Mat
PNV107RAH	RAL code 9003	RAL codes 9003	Matt	Mat
PNV107ORH	24K gold	24K or	Shiny	Brillant
PNV107OMH	24K microbilled gold	microbillé 24K or	Satin	Satin

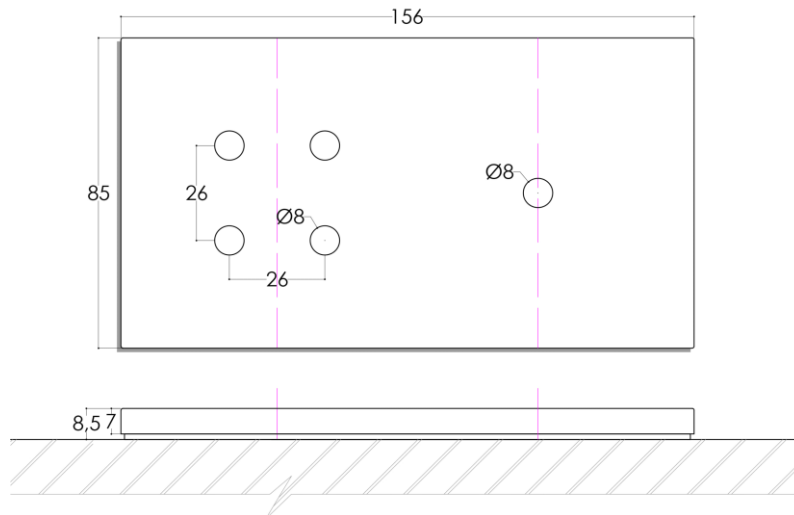

NEVA

FRONT PLATE

FACE AVANT

Description

Material : full brass.

Windows opening : 5 round holes for PB (ABCD, E).

Button: round buttons.

Silicone: to reduce sound impact between buttons and face plate.

POSITION

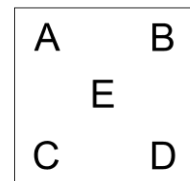

Caractéristiques

Matière : laiton massif.

Fenêtre : 5 ouvertures rondes pour BP (ABCD, E).

Bouton: boutons ronds.

Silicone : réduit l'impacte du son entre le bouton et la face avant.

Ref.	Finish	Finition	Effect	Effet
PNV121LMH	Polished mirror brass	Laiton miroir	Shiny	Brillant
PNV121LBH	Brushed brass	Laiton brossé	Matt	Mat
PNV121LSH	Microbilled/satin brass	Laiton microbillé	Satin	Satin
PNV121VOH	Antique/old gold	Vieil or	Matt	Mat
PNV121BMH	Medium bronze	Bronze moyen	Matt	Mat
PNV121BRH	Dark bronze	Bronze noir	Shiny	Brillant
PNV121BZH	Grey bronze	Bronze gris	Matt	Mat
PNV121NMH	Polished mirror nickel	Nickel miroir	Shiny	Brillant
PNV121NBH	Brushed nickel	Nickel brossé	Matt	Mat
PNV121NSH	Microbilled/satin nickel	Nickel brossé	Matt	Mat
PNV121CHH	Polished mirror chrome	Chrome miroir	Shiny	Brillant
PNV121ROH	Brushed copper	Cuivre brossé	Matt	Mat
PNV121RAH	RAL code 9003	RAL codes 9003	Matt	Mat
PNV121ORH	24K gold	24K or	Shiny	Brillant
PNV121OMH	24K microbilled gold	microbillé 24K or	Satin	Satin

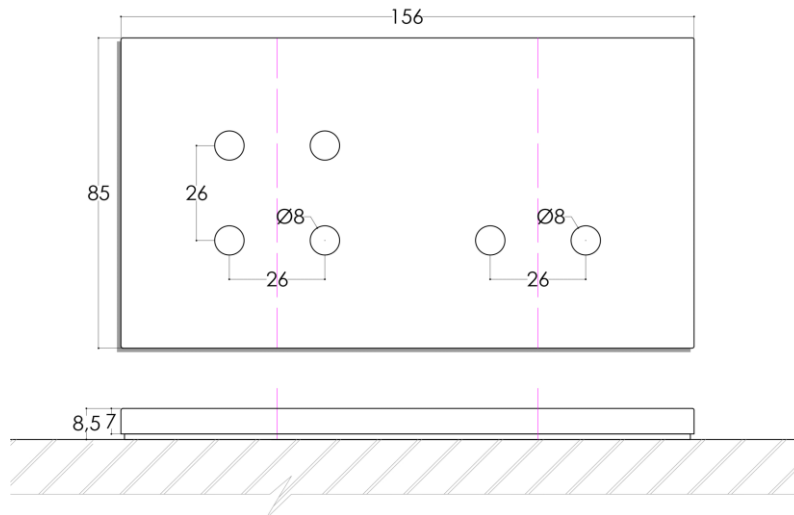

NEVA

FRONT PLATE

FACE AVANT

Description

Material : full brass.

Windows opening : 6 round holes for PB (ABCD, CD).

Button: round buttons.

Silicone: to reduce sound impact between buttons and face plate.

POSITION

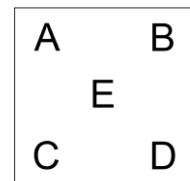

Caractéristiques

Matière : laiton massif.

Fenêtre : 6 ouvertures rondes pour BP (ABCD, CD).

Bouton: boutons ronds.

Silicone : réduit l'impacte du son entre le bouton et la face avant.

Ref.	Finish	Finition	Effect	Effet
PNV149LMH	Polished mirror brass	Laiton miroir	Shiny	Brillant
PNV149LBH	Brushed brass	Laiton brossé	Matt	Mat
PNV149LSH	Microbilled/satin brass	Laiton microbillé	Satin	Satin
PNV149VOH	Antique/old gold	Vieil or	Matt	Mat
PNV149BMH	Medium bronze	Bronze moyen	Matt	Mat
PNV149BRH	Dark bronze	Bronze noir	Shiny	Brillant
PNV149BZH	Grey bronze	Bronze gris	Matt	Mat
PNV149NMH	Polished mirror nickel	Nickel miroir	Shiny	Brillant
PNV149NBH	Brushed nickel	Nickel brossé	Matt	Mat
PNV149NSH	Microbilled/satin nickel	Nickel brossé	Matt	Mat
PNV149CHH	Polished mirror chrome	Chrome miroir	Shiny	Brillant
PNV149ROH	Brushed copper	Cuivre brossé	Matt	Mat
PNV149RAH	RAL code 9003	RAL codes 9003	Matt	Mat
PNV149ORH	24K gold	24K or	Shiny	Brillant
PNV149OMH	24K microbilled gold	microbillé 24K or	Satin	Satin